

NOTES:

- 1. SUBSTRATE:
ZERODUR®
- 2. SURFACE S2 TO BE PARALLEL TO SURFACE S1 TO WITHIN 30 ARCSEC
- 3. COATING (APPLY ACROSS CLEAR APERTURE)
S1: R(abs) >99.5% @ 635, 670 & 1064nm
- DAMAGE THRESHOLD, BY DESIGN:
20 J/cm2 @ 1064nm
- S2: NONE
- 4. FINE GRIND SURFACE
- 5. POWER, IRREGULARITY, AND SURFACE QUALITY SPECIFICATIONS APPLY
ACROSS CLEAR APERTURE
- 6. CLEAR APERTURE AND COATING APERTURE ARE CENTERED ON SURFACES

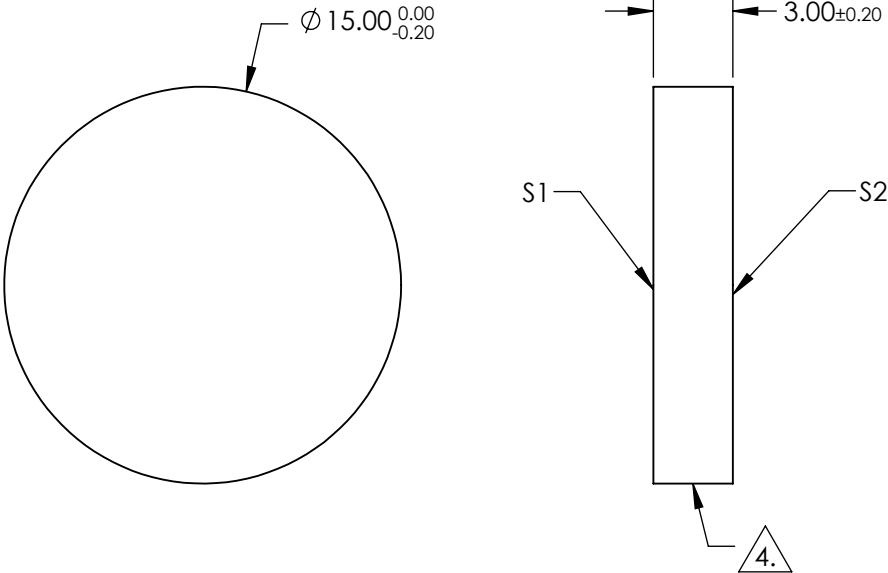
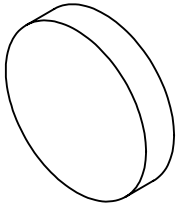

**FOR INFORMATION ONLY:
DO NOT MANUFACTURE
PARTS TO THIS DRAWING**

SPECIFICATIONS SUBJECT TO CHANGE WITHOUT NOTICE
DIMENSIONS ARE FOR REFERENCE ONLY

	S1	S2	<div><div><div><div><div></div></div></div><div><div></div></div></div><div><div>Edmund Optics®</div></div></div> <div><div>TITLE</div><div>15.0mm Dia x 3mm 635-670/1064nm, Zerodur Dual Band Laser Mirror</div></div> <div><div>DWG NO</div><div>29063</div></div> <div><div>SHEET</div><div>82 OF 86</div></div>			
SHAPE	PLANO	PLANO				
SURFACE QUALITY	20 - 10	COMMERCIAL POLISH	<div>THIRD ANGLE PROJECTION</div> <div></div>	<div>ALL DIMS IN</div> <div>mm</div>		
SURFACE FLATNESS	λ/10	N/A				
CLEAR APERTURE	Ø 13.500	N/A				
COATING APERTURE	Ø 13.500	N/A				
BEVEL	PROTECTED AS NEEDED	PROTECTED AS NEEDED				