

NOTES:

1. SUBSTRATE:
FUSED SILICA
2. SURFACE S2 TO BE PARALLEL TO SURFACE S1 TO WITHIN <3 ARCMIN
3. COATING (APPLY ACROSS CLEAR APERTURE)
S1: R(avg) > 90% @ 625 - 650nm @ 45° AOI
Rs & Rp(abs) ≥99.5% @755; |Rs-Rp| ≤0.5% @ 45° AOI

S2: NONE

4. FINE GRIND SURFACE

5. POWER, IRREGULARITY, AND SURFACE QUALITY SPECIFICATIONS APPLY
ACROSS CLEAR APERTURE

6. CLEAR APERTURE AND COATING APERTURE ARE CENTERED ON SURFACES

7. ARROW ON EDGE POINTS TOWARDS S1

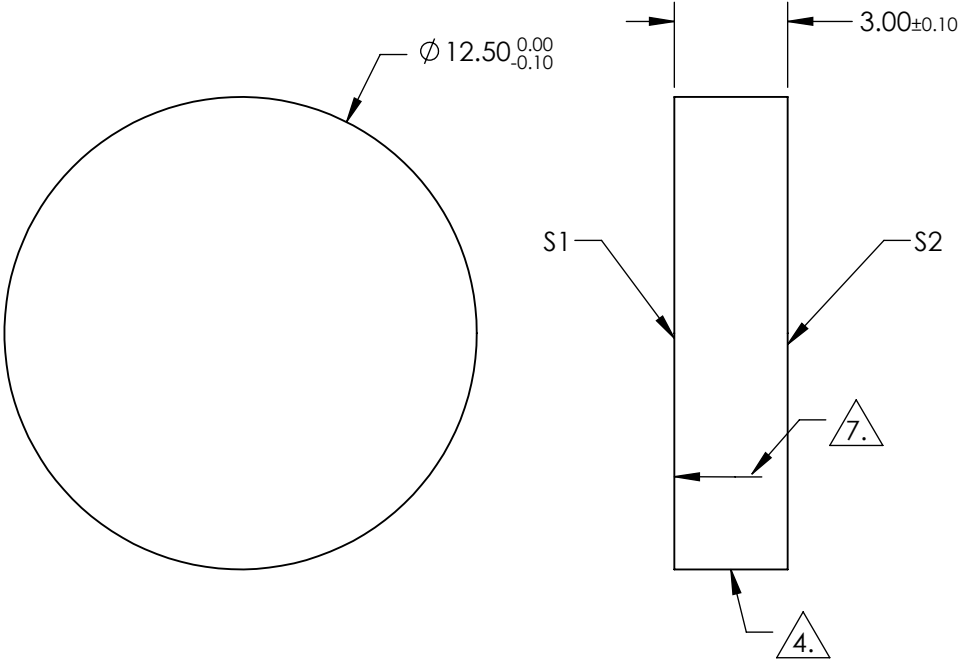
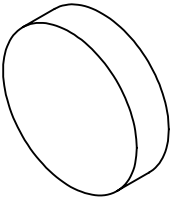

**FOR INFORMATION ONLY:
DO NOT MANUFACTURE
PARTS TO THIS DRAWING**

SPECIFICATIONS SUBJECT TO CHANGE WITHOUT NOTICE
DIMENSIONS ARE FOR REFERENCE ONLY

	S1	S2				
SHAPE	PLANO	PLANO	<div><div><div><div><div><div></div></div></div><div>THIRD ANGLE PROJECTION</div></div><div><div>ALL DIMS IN</div><div>mm</div></div></div><div><div>TITLE</div><div>12.5mm Dia., 3mm Thick, Fused Silica 755/632nm Alexandrite Mirror, 45 Deg AOI</div></div><div><div>DWG NO</div><div>25535</div></div><div><div>SHEET</div><div>3 OF 86</div></div></div>			
SURFACE QUALITY	10 - 5	COMMERCIAL POLISH				
SURFACE FLATNESS	$\lambda/10$	N/A				
CLEAR APERTURE	$\varnothing 11.25$	N/A				
COATING APERTURE	$\varnothing 11.25$	N/A				
BEVEL	PROTECTED AS NEEDED	PROTECTED AS NEEDED				

Edmund Optics®