

FOCAL LENGTH (EFL):  $3 \pm 0,03$   
 BACK FOCAL LENGTH (BFL): 2,21

1 AR COATING: VIS-EXT  
 $R(\text{AVG}) \leq 0,5\%$  FROM 350-700nm @ 0° AOI

LEFT SURFACE		MATERIAL	RIGHT SURFACE	
R	$3,5 \pm 0,004$ CX	GLASS N-SF5 673/322	R	$3,5 \pm 0,004$ CX
Øe	2,5		Øe	2,5
3/	3 (0,5) $\lambda=632,8$ nm		3/	3 (0,5) $\lambda=632,8$ nm
4/	-		4/	66,86'
5/	20 - 10 (MIL-PRF-13830B)		5/	20 - 10 (MIL-PRF-13830B)
6/	-		6/	-

PROTECTIVE CHAMFERS AS NEEDED

ROHS: COMPLIANT  
 SCALE: NONE  $\lambda = 587,6$ nm

SPECIFICATIONS SUBJECT TO CHANGE WITHOUT NOTICE. DIMENSIONS ARE FOR REFERENCE ONLY

FOR INFORMATION ONLY: DO NOT MANUFACTURE PARTS TO THIS DRAWING

INDICATIONS IN ACCORDANCE WITH ISO 10110

FIRST ANGLE PROJECTION

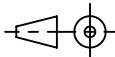

ALL DIMS IN: mm

**EO**® Edmund Optics®

TITLE 3mm Dia, x 3mm FL, VIS-EXT Coated, Double-Convex Lens

DWG NO 89118

SHEET SIZE A4 SHEET 1 OF 1